

# Milano

Care and Cleaning:

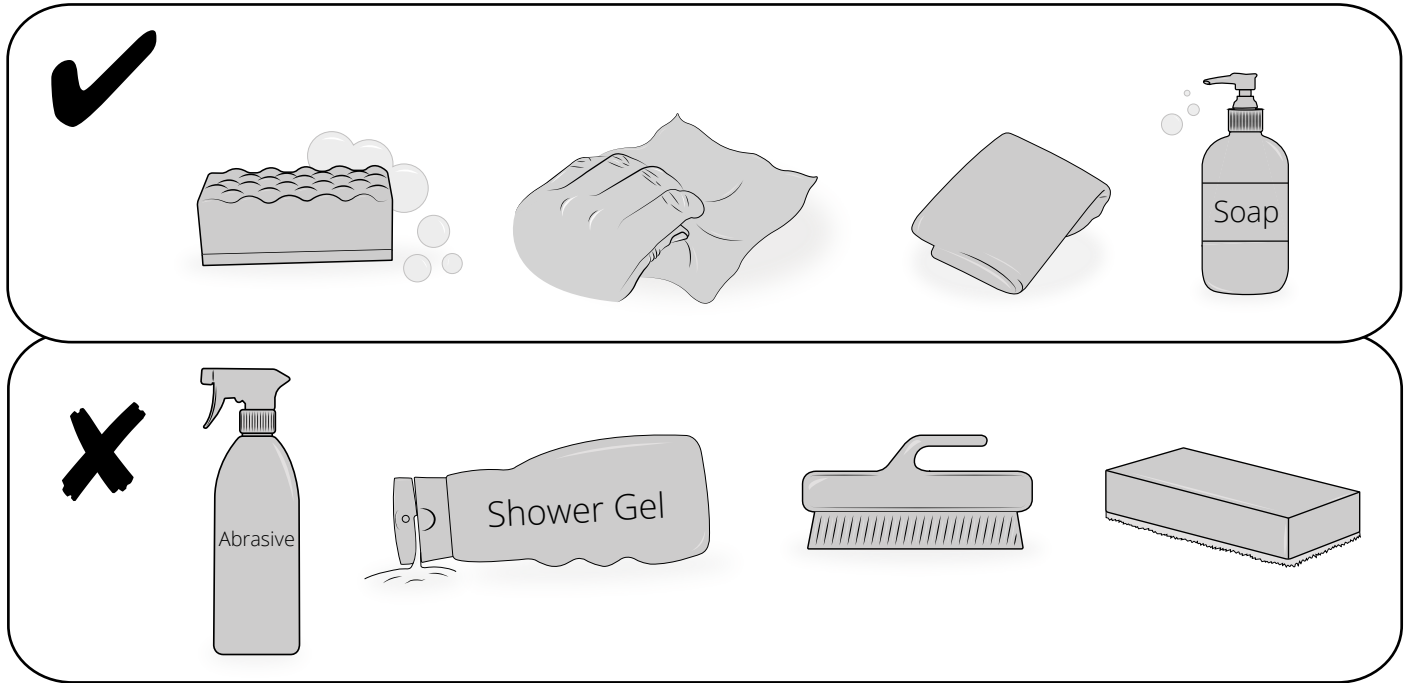

## **Bathroom Furniture Cleaning Instructions**

*Bathroom furniture, bath panels and seats are constructed from engineered wood. To prevent damage to the surface, do not let water pool for a long period of time and dry immediately with a soft cloth. Simply use a soft damp cloth to clean wooden bathroom products.*

*Avoid using scouring powder, scourers and abrasive cleaners on a wooden surface.*

*It's essential to keep your bathroom ventilated either by opening the window or fitting an extractor fan to help prevent condensation building up.*

*Any cut edges must be sealed with a good quality bathroom sealant to stop water ingress.*